

WELCOME

As one of Texas' oldest Episcopal churches, the Cathedral has continually been a vibrant and active community parish for over 170 years. The Cathedral lives everyday into its mission "to proclaim the love of Jesus Christ through word and deed to the parish, the diocese and the downtown community."



IMPORTANT NUMBERS

Cathedral Main Line.....	713-222-2593
Cathedral Fax Line	713-222-2412
Cathedral Bookstore	713-590-3336
Diocese of Texas	713-520-6444
The Beacon	713-220-9737
Cathedral House Episcopal School	713-222-2482
Brigid's Place	713-590-3333
Cloister Gallery	713-590-3334

DURING THE WEEK

- Bible Studies** Tuesdays at 9:30 a.m. for Women
 Wednesdays at 7:00 a.m. for Men
- Cathedral Offices** Monday – Friday, 8:00 a.m. to 5:00 p.m.
 Summer Hours 8:00 a.m. to 4:00 p.m.
- Cathedral Bookstore** Monday – Friday, 10:00 a.m. to 2:00 p.m.
 Sundays, 8:45 a.m. to 12:30 p.m.
 Closed weekdays in Summer

GETTING HERE

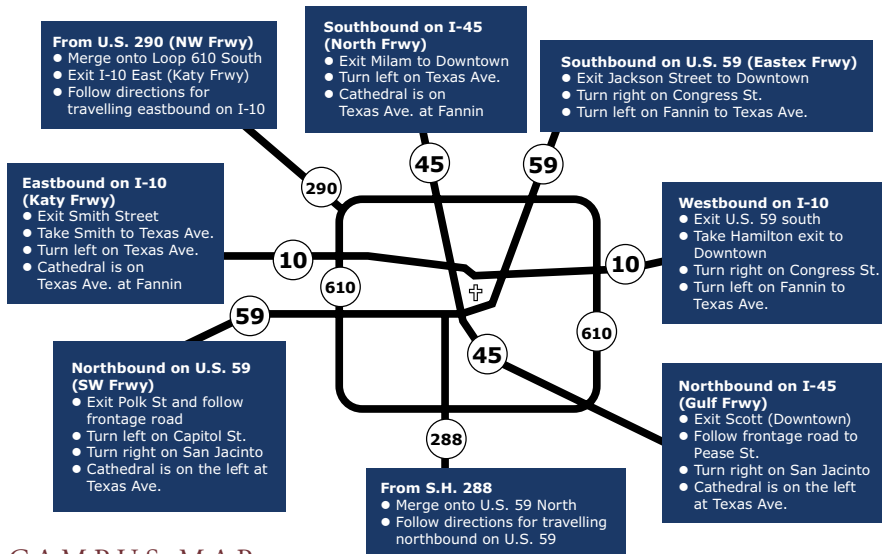

CAMPUS MAP
ON REVERSE

WORSHIP SERVICES

Sunday

- 8:00 The Holy Eucharist, Rite I
- 9:00 The Holy Eucharist, Rite II
- 10:00 Education Hour for all ages
- 11:00 The Holy Eucharist, Rite I
- 1:00 La Santa Eucaristía, Rito II
- 1:00 Rhythms of Grace (*first Sunday of each month*)
- 5:00 The Holy Eucharist, Rite II

Monday through Friday

- 7:30 Morning Prayer in Golding Chapel
- 12:05 The Holy Eucharist in Golding Chapel
Includes a Service of Healing on Fridays
- 6:00 Evening Prayer in Golding Chapel

LEADERSHIP

The Very Rev. Joe D. Reynolds, *Dean*
 The Rev. Edward L. Stein, *Canon Precentor*
 The Rev. James C. McGill, *Canon Missioner*
 The Rev. James M. L. Grace,

Canon for Christian Formation

The Rev. Betty Adam, *Canon Theologian*
 The Rev. John A. Logan, *Canon Emeritus*
 The Rev. Glenice Robinson-Como,
Chaplain to The Beacon

Jeremy Bradley, *Director of Youth and Young Adult Ministries*



Jen Frazer, *Director of Communications*
 Bruce Power, *Cathedral Organist*
 Lisa Puccio, *Director of Family Ministry*
 David Simpson, *Director of Stewardship*
 Robert Simpson, *Canon for Music*
 Melissa White, *Director of Membership Development*

Bill Kovach, *Chief Administrative Officer*
 Anne Shepard, *Parish Records / Weddings Liaison*





CHRIST CHURCH CATHEDRAL CAMPUS MAP

-  = Men's restroom
-  = Women's restroom
-  = Elevator

Jones Building Basement

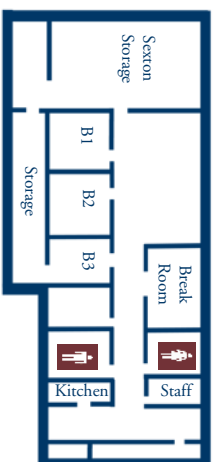

Ballard Youth Center McGehee Third Floor

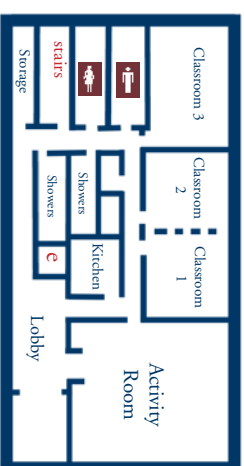

Prairie Street

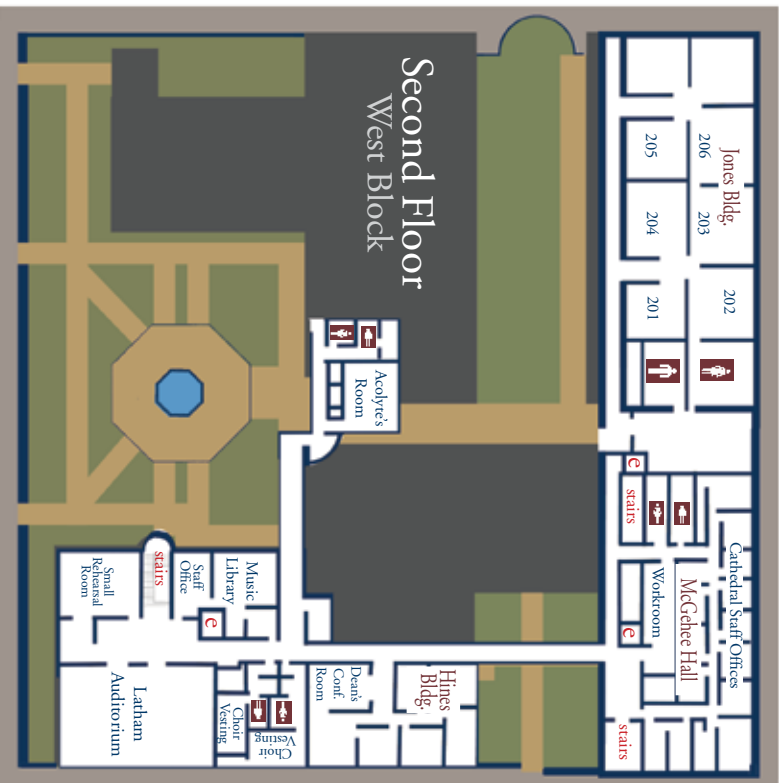

Fannin Street

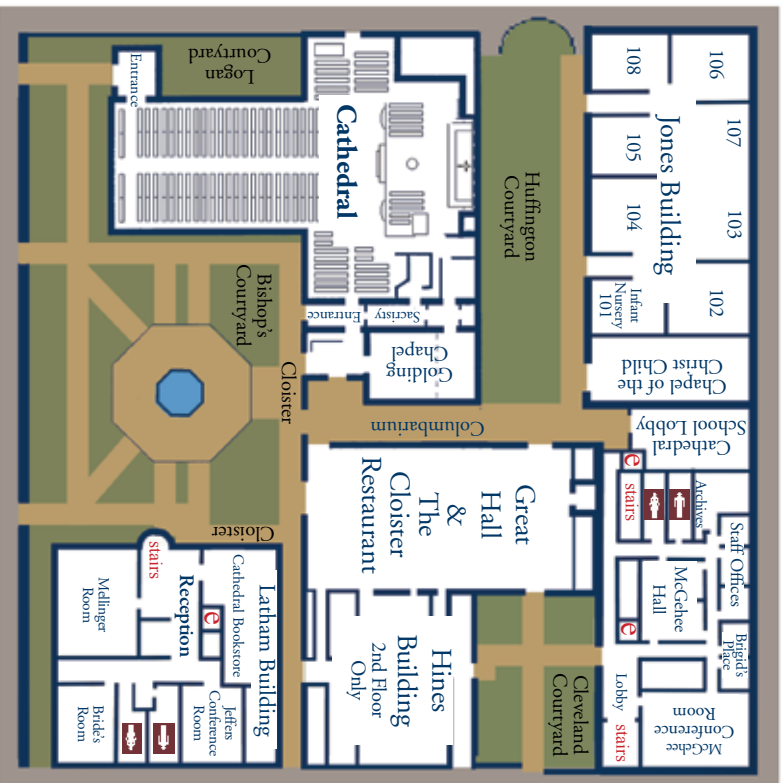

San Jacinto Street

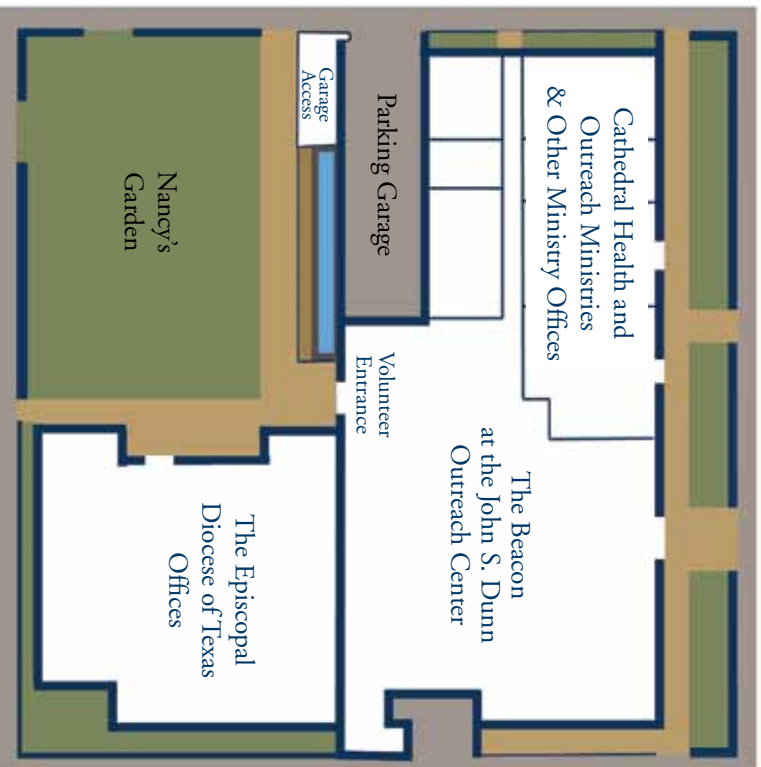

Caroline Street

Texas Avenue