

WELCOME

As one of Texas' oldest Episcopal churches, the Cathedral has continually been a vibrant and active community parish for over 170 years. The Cathedral lives everyday into its mission "to proclaim the love of Jesus Christ through word and deed to the parish, the diocese and the downtown community".



IMPORTANT NUMBERS

Cathedral Main Line.....	713-222-2593
Cathedral Fax Line	713-222-2412
Cathedral Bookstore	713-590-3336
Diocese of Texas	713-520-6444
The Beacon	713-220-9737
Cathedral House Episcopal School.....	713-222-2482
Brigid's Place	713-590-3333
Cloister Gallery	713-590-3334

DURING THE WEEK

Bible Studies	Tuesdays at 9:30 a.m. for Women Wednesdays at 7:00 a.m. for Men Wednesdays at 6:15 p.m. for Women
Cathedral Offices	Monday - Friday, 8:00 a.m. to 5:00 p.m. Summer Hours 8:00 a.m. - 4:00 p.m.
Cathedral Bookstore	Monday - Friday, 10:00 a.m. to 2:00 p.m. Sundays; 8:45 a.m. - 12:30 p.m. Closed weekdays in Summer

GETTING HERE

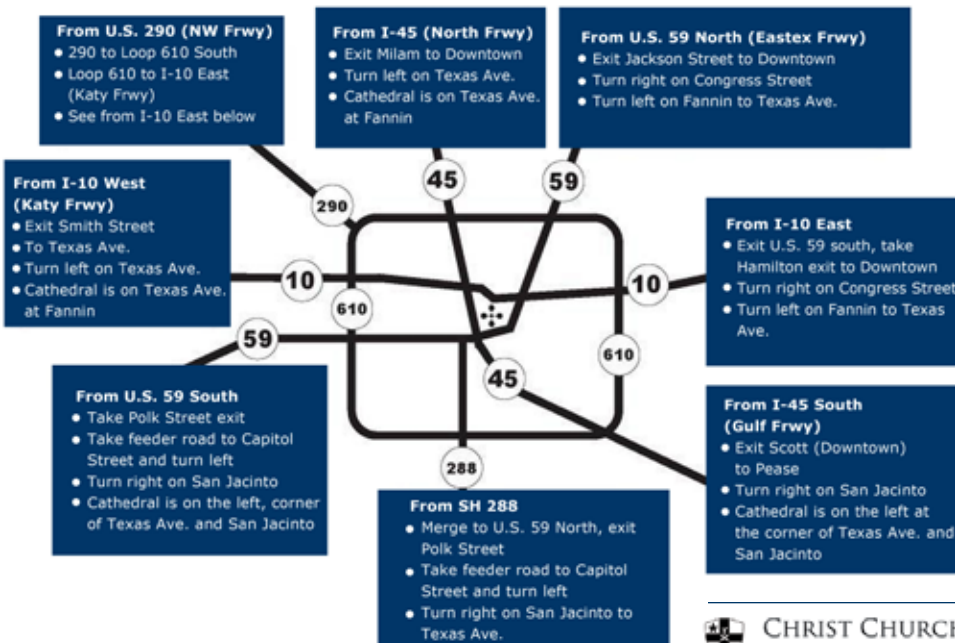

WORSHIP SERVICES

Sunday

8:00	The Holy Eucharist, Rite I
9:00	The Holy Eucharist, Rite II
10:00	Education Hour for all ages
11:00	The Holy Eucharist, Rite I
1:00	La Santa Eucaristia
5:00	The Holy Eucharist, Rite II

Monday through Friday

7:30	Morning Prayer in Golding Chapel
12:05	The Holy Eucharist in Golding Chapel*
6:00	Evening Prayer in Golding Chapel

*On Friday, the 12:05 Eucharist includes a Service of Healing

LEADERSHIP

- The Very Reverend Joe Reynolds, *Dean*
- The Reverend Betty Adam, *Canon Theologian*
- The Reverend Luchy Littlejohn, *Canon Pastor*
- The Reverend John Logan, *Canon Emeritus*
- The Reverend Jim McGill, *Canon Missioner*
- The Reverend Rhoda Montgomery, *Canon for Christian Formation*
- The Reverend Ed Stein, *Canon Precentor*
- Anne Shepard, *Membership/Weddings*
- Bill Kovach, *Chief Administrative Officer*
- Bruce Power, *Cathedral Organist*
- David Simpson, *Director of Stewardship*
- Eileen O'Brien, *Director of Youth and Young Adult Ministry*
- John Giffin, *Facility Administrator*
- Lisa Puccio, *Director of Family Ministry*
- Melissa White, *Director of Membership Development*
- Norma Riehle, *Director of Communications*
- Robert Simpson, *Canon for Music*
- Sandra Montes, *Asst. for Multicultural Ministries*
- Tracie Jae, *Program Coordinator*





CHRIST CHURCH CATHEDRAL CAMPUS MAP

= Men's restroom

= Women's restroom

= Elevator

Jones Building Basement

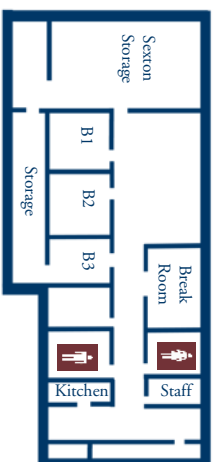

Ballard Youth Center McGehee Third Floor

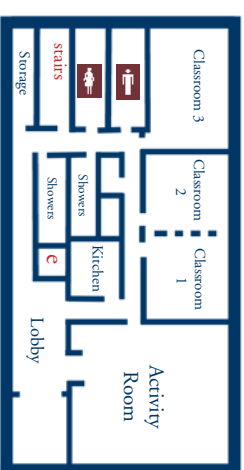

Prairie Street

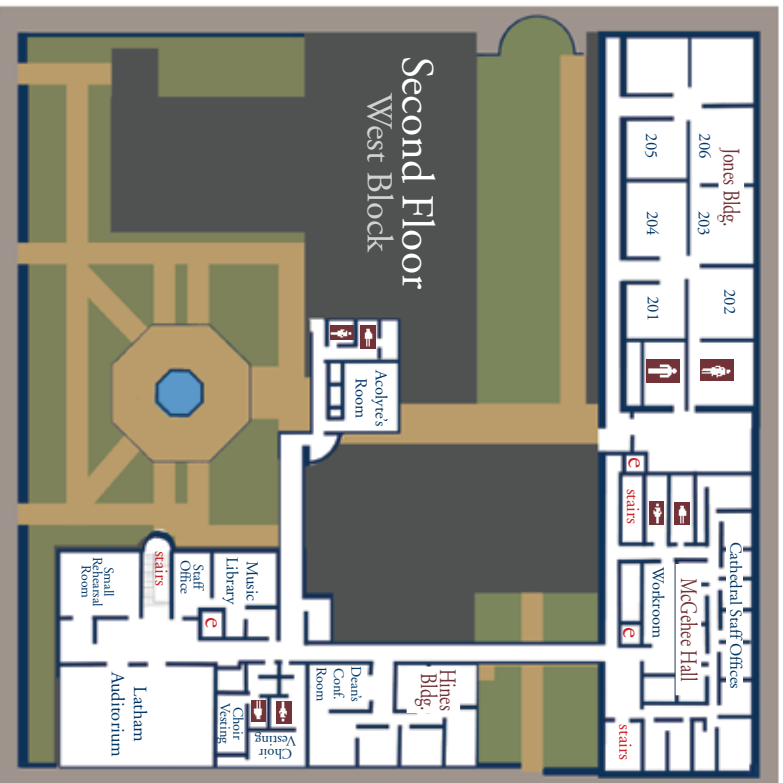

Fannin Street

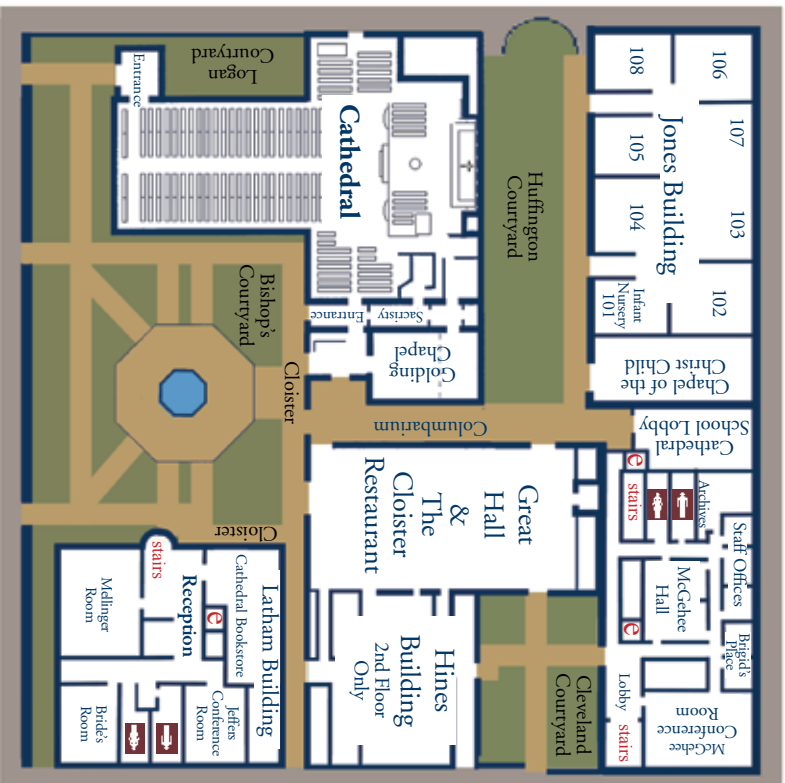

San Jacinto Street

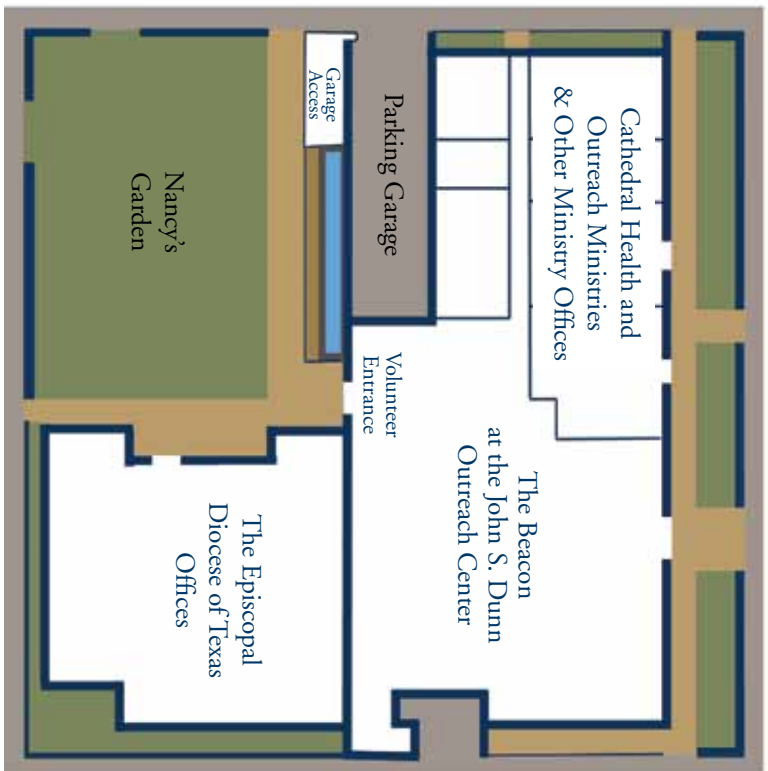

Texas Avenue

Caroline Street